



I-45 Corridor Program - Bryan District

Project Information Meeting
Friday, December 1, 2023

December 1, 2023



Thanks for joining our virtual meeting!

- Be sure your full name is showing up correctly to provide your information on the attendee list.
- Please ensure your audio is muted and video turned off.
- Note that all correspondence will be muted throughout this presentation.
- There **will not** be an opportunity to ask questions during the Pre- RFP presentation.
- You **will** be given an opportunity to ask questions after the presentation via an **email request**.



1	Safety Moment	PEPS
2	Introductions & Ground Rules	PEPS
3	Procurement Overview & Process	PEPS
4	Preclusions	PEPS
5	I-45 Corridor Program – Bryan District Overview	BRY
6	Procurement Timeline (Tentative)	PEPS
7	Wrap Up & Next Steps	PEPS



HELP
#EndTheStreakTX

End the streak of daily deaths on Texas roadways.

TxDOT.gov (Keyword: #EndTheStreakTX)



#EndTheStreakTX Toolkit





- PEPS Central Service Center Manager (LRD)
 - Jaime A. Vela, Jr., P.E.

- PEPS Procurement Engineer (BRY)
 - Allison Kurwitz, P.E.

- PEPS Contract Specialist ()
 - TBD

- District Program Manager (I-45 Corridor Program):
 - Neal Riddle, P.E.: Project Development Engineer - Bryan District (BRY)

PLEASE - Do NOT Contact Bryan District I-45 Program Manager



GROUND RULES

1. Do not contact the Bryan District Program Manager.
Once CST members are identified, do not contact them.
2. Communication is one-way during this presentation.
3. Brief Presentation – Information Purposes Only
4. All questions must be emailed to allison.kurwitz@txdot.gov .
by 5:00 p.m. on Friday, December 15, 2023.
Subject line: I-45 Corridor Program Meeting Question



- One Procurement – Four (4) Specific Deliverable Contracts
 - Federal with Interviews, DBE
 - Schematic, Environmental, Plans, Specifications and Estimates (SEP)
 - With Work Authorizations
 - 4 Schematics
 - 8 PS&E Packages
- Projected for FY 2024 Wave 4
- Anticipated Duration: 7 years



Four Specific Deliverable Contracts with Work Authorizations Contract Duration: 7 Years



FEDERAL FUNDS

DBE GOAL

- TBD%

FEDERAL PROCESS WITH INTERVIEWS

- Solicitation – The Request for Proposal (RFP)
- Response – Proposal submitted in Bonfire
- Short List – Based on the proposal scores
- Interviews – Provider presentation
- Selection – Based on the interview scores



Precluded Firms*

Firms that were contracted to work as a Prime or Subprovider under the following contracts:

❖ 17-OSDP5003 (BRY I-45 GEC)

- Atkins North America, Inc. – Prime
 - Subproviders:
 - K Friese & Associates, Inc., a Lochner Company
 - Landtech, Inc.
 - Lonestar Program Controls Group, LLC
 - Nancy Ledbetter & Associates, Inc.
 - Transcend Engineers & Planners, LLC
 - Ulteig Engineers, Inc.
 - WSP USA Environment & Infrastructure Inc. (formerly Wood Environment & Infrastructure Solutions, Inc.)
 - Soloray Engineering, Inc.

* List is subject to change – current as of 11/28/23



Precluded Firms*

Firms that were contracted to work as a Prime or Subprovider under the following contracts:

- ❖ **17-0IDP5003 (BRY CEC)**
 - Johnson, Mirmiran & Thompson, Inc. – Prime

- ❖ **17-0IDP5005 (BRY CEC)**
 - LJA Engineering, Inc. – Prime

* List is subject to change – current as of 11/28/23



- Preclusion Appeals Process
 - Preclusion document has been developed.
 - Email Martin L. Rodin, P.E.
 - Include subject I-45 Corridor Program – Bryan District
 - Explain rationale for removal from preclusion list
 - After posting procurement
 - Formal appeal outlined in Title 43 TAC § 9.7, see for exact details
 - Mail letter to Marc D. Williams, include above info
 - CC: Martin L. Rodin
 - Procurement process is not paused

- Core Team Restrictions
 - None anticipated

I-45 Corridor Program – Bryan District: Snapshot



- A program to improve safety and mobility on 90.4 miles of IH 45 through Walker, Madison, Leon, and Freestone Counties
- Characteristics:
 - Rural environment with narrow depressed medians
 - Few interchanges, mostly at small communities
 - Long rural stretches of two-way frontage roads only on one side and Access Denial Lines on the other
 - Urban frontage roads have two-way frontage roads on both sides and require conversion to one-way operation
 - Phased funding for construction requires corridor to be broken into smaller projects
- Scope:
 - 15 construction projects (**Segments**) totaling: ~\$ 2.4 billion in estimated construction costs
 - 8 contracts totaling: ~\$ 122 million in estimated schematic, environmental, ROW, utility, and design costs

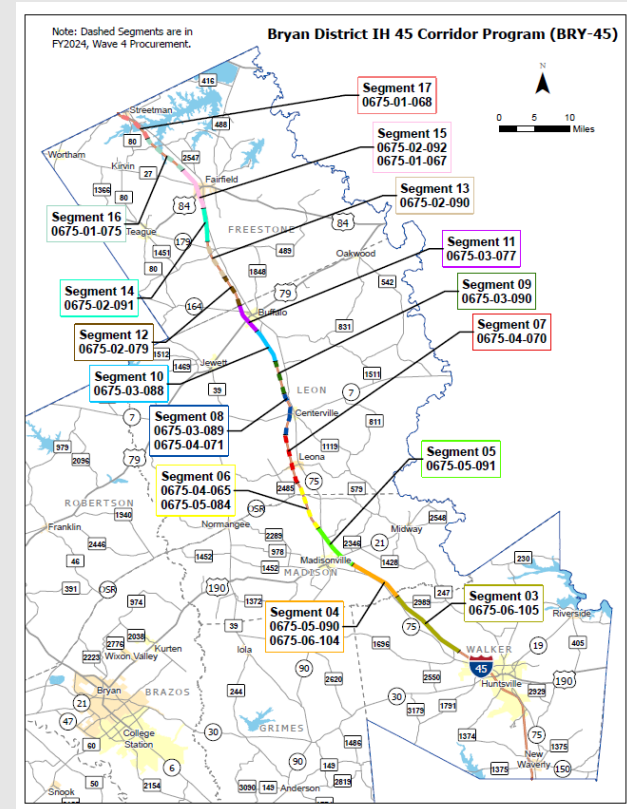

I-45 Corridor Program – Bryan District: Goals and Objectives



- Increase capacity (including for hurricane evacuations)
- Enhance safety within the corridor
- Improve interchanges (including use of innovative intersections)
- Minimize need for utility relocations and right-of-way acquisition
- Enhance bicycle and pedestrian options



Example of Completed IH 45 Main Lanes

I-45 Corridor Program – Bryan District: Overview



- Project Development Engineers (PDE): 8 Firms Total (4 Firms for this Procurement)
- Schematics: 8 ranging in length from 9 to 14 miles (4 Schematics for this Procurement)
- Segments: 15 ranging in length from 5 to 11 miles (8 PS&E packages, 1 per Segment)
 - I-45 Corridor Program encompasses Seg-03 thru Seg-17
 - Seg-01a & 01b have been completed.
 - Seg-02a is under construction.
 - Seg-02b has a completed PS&E and will not be a part of the GEC program.
- Construction Cost: Approximately \$ 200 million per Segment



Example of low clearance/short span railroad structure

I-45 Corridor Program – Bryan District: Corridor Map

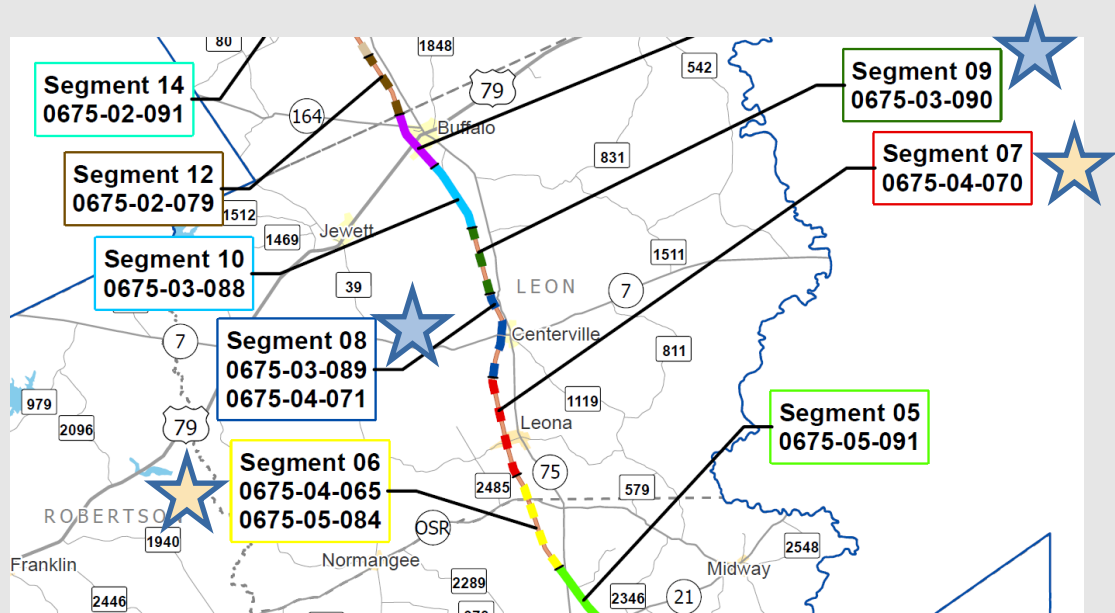
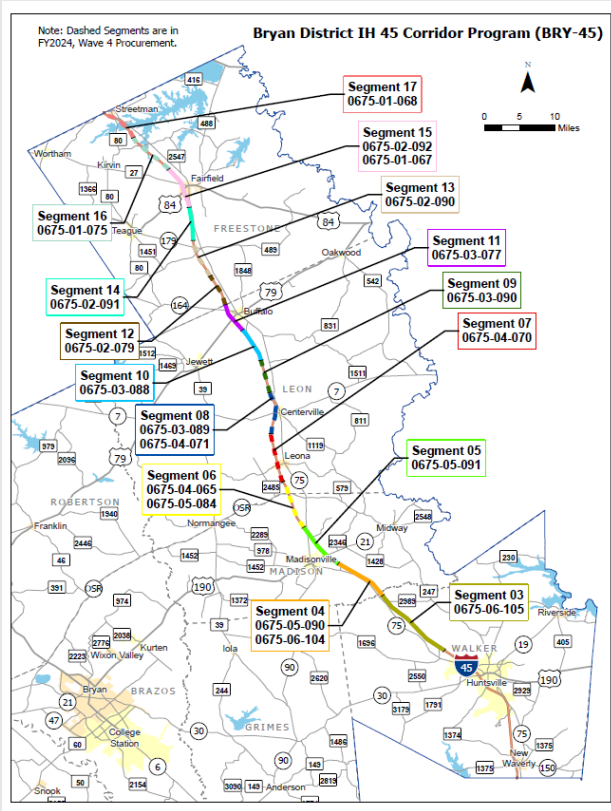

I-45 Corridor Program – Bryan District: Corridor Map, cont.

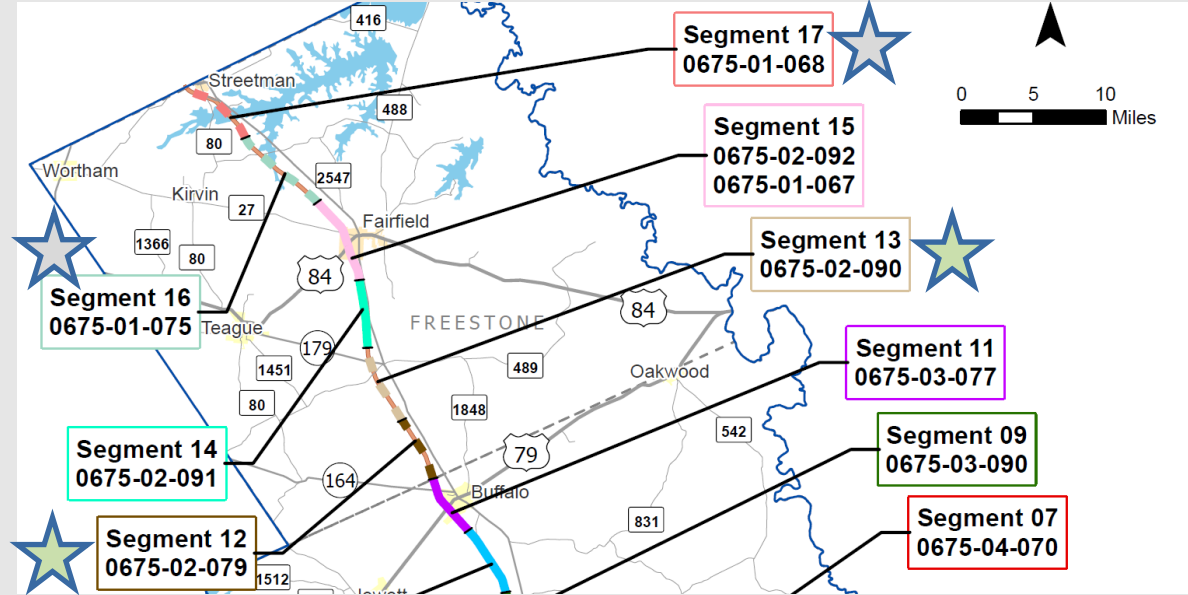
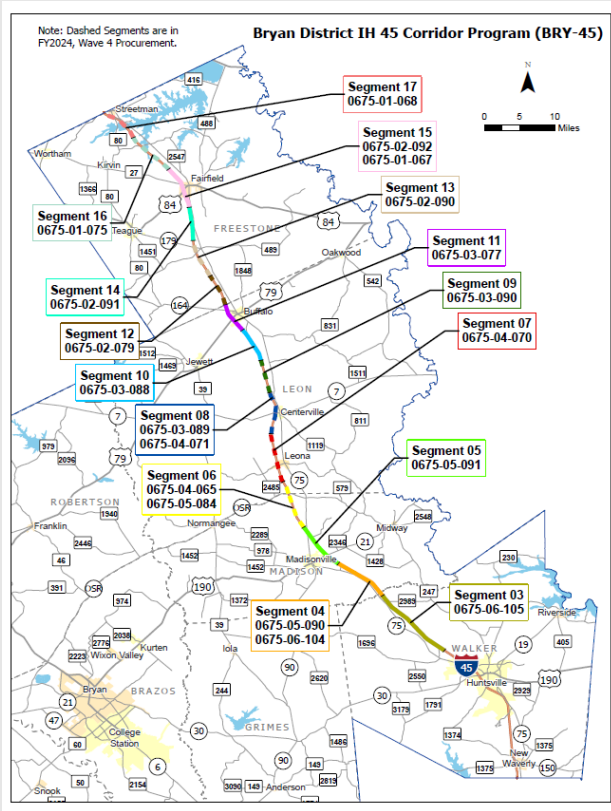

I-45 Corridor Program – Bryan District: Typical Sections

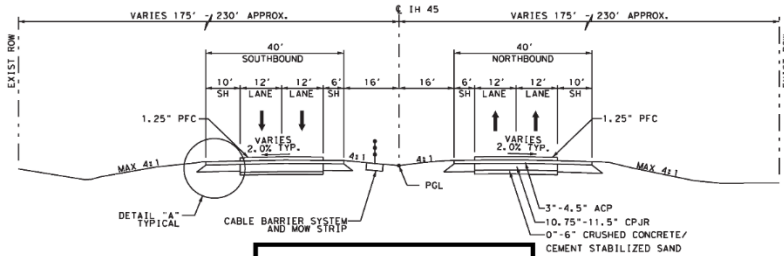

Existing Typical Section

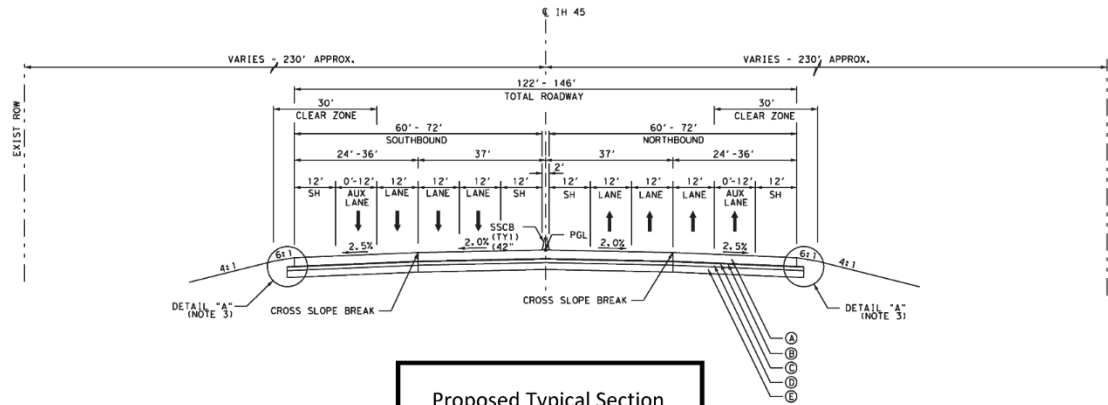

Proposed Typical Section

I-45 Corridor Program – Bryan District: Information for Download



BRY-45 CORRIDOR PROGRAM

BRYAN DISTRICT

November 2023

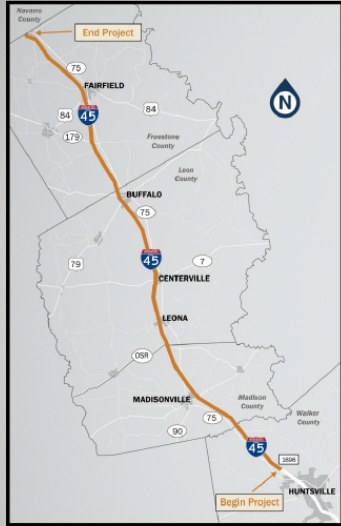

PROJECT DETAILS

Limits: From FM 1696 to the Freestone/Navarre County line
 Counties: Walker, Madison, Leon and Freestone
 Length: 90.4 miles
 Estimated Cost: \$2.4 billion

PROJECT HISTORY

Interstate 45 (I-45) was approved in 1962 by the Texas State Highway Commission. Built in the 1960s and 1970s, I-45 in Walker, Madison, Leon and Freestone counties is approximately 40-60 years old. As the main connection between Dallas and Houston, I-45 is a key Texas travelers. I-45 is one of the three interstates that make up the Texas Triangle, a region of the state's three main urban centers (Dallas, Houston and San Antonio). The triangle is called the Texas Demographic Center, it is estimated that 87% of Texas's total population lives within the triangle.

PROJECT BENEFITS

- Improve safety and mobility.
- Prepare for future traffic volumes.
- Update the roadway to current design standards.
- Provide better traffic flow at interchanges.
- Improve access for hurricane evacuation routes.
- Enhance freight movement.
- Enhance bicycle and pedestrian accommodation.
- Increase truck parking at rest areas.

PROJECT GOALS

- Improve:
 - Safety and mobility.
 - Bicycle and pedestrian operations.
 - Hurricane evacuation effectiveness.
 - Freight movement.
- Minimize need for utility relocations and acquisition.

CURRENT PROJECT STATUS

- Public involvement will be continuous throughout development.
- Preliminary planning and engineering are in the final stages.
 - Planning includes a detailed environmental review.

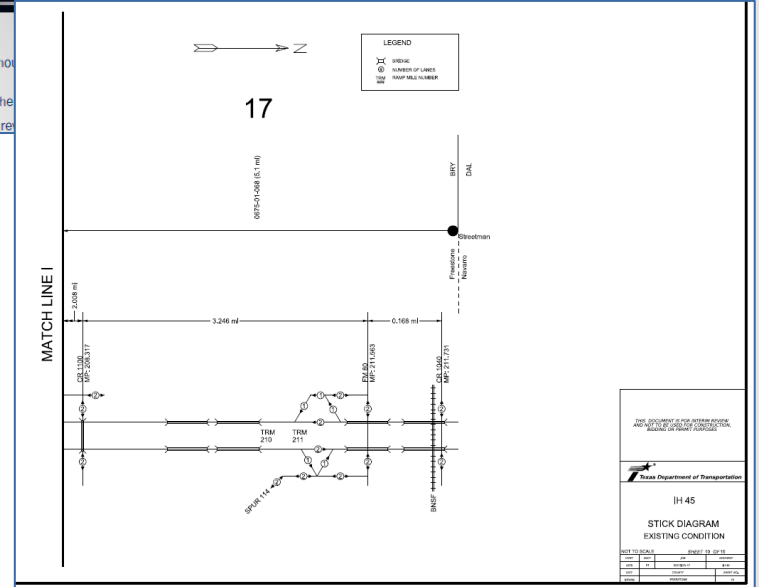
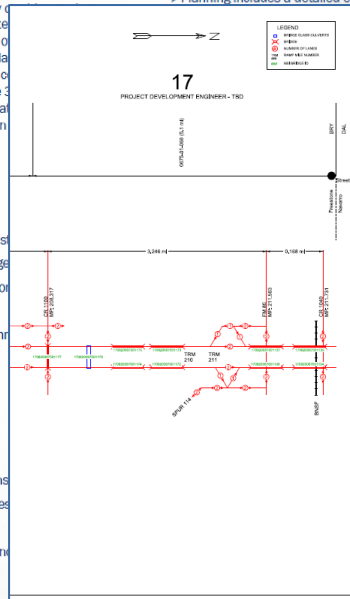



BRY-45 Program - Summary of GEC Responsibilities

- I. Acronyms and Definitions
 - A. BRY-45 – Bryan District IH 45 Corridor program
 - B. BRY – Texas Department of Transportation Bryan District
 - C. GEC - General Engineering Consultant which includes
 - D. IAJR – Interstate Access Justification report
 - E. LDP – Low Distortion Projection which is a custom
 - F. PDE - Project Development Engineer who is responsible on BRY-45
 - G. Segment – specific section of IH 45 in BRY-45 department
 - H. SM – Segment Manager who is a member of GEC Segment Manager
 - I. SME - Subject Matter Expert: Members of BRY and their expertise and coordination between TxDOT, GEC, and

BRY-45 General Engineering Consultant

BRY-45 Standard Operating Procedures			
Title: Table of Contents			TOC-1
Original Issue Date: 04/06/2023		Revision <u> 3.0 </u> , Issue Date: 10/10/2023	
Procedure No.	Procedure Title/Description	Rev No.	Date
TOC-01	Table of Contents	0.0	10/10/2023
Section 1 - Quality Management System Introduction			
ES-01	Program QMS Procedures Executive Summary	0.1	6/16/2023
QMS-01	Program Management Plan	1.0	6/26/2023
QMS-02	Quality Management Plan	1.0	6/16/2023
Section 2 - GEC Organizational Management			
ORM-01	Program Orientation Guide	1.0	5/23/2023
ORM-03	Team Roles and Responsibilities	1.0	6/26/2023
ORM-04	Program Organizational Chart	5.0	10/6/2023
Section 3 - Contract Management			
CSM-01	Contracting Guidance for PDEs		<i>pending</i>
CSM-02	Contracting Checklist		<i>pending</i>
CSM-03	Contracting Definition		<i>pending</i>
CSM-04	Work Authorization Scope Language	<i>pending</i>	<i>pending</i>
CSM-04-F01	Work Authorization Fee Spreadsheet (.xlsx)		<i>pending</i>
CSM-05	Invoice Procedures	1.0	5/31/2023
CSM-05-T01	PDE Progress Reports		<i>pending</i>
CSM-05-T02	GEC Progress Reports		<i>pending</i>
Section 4 - Communications			
C-01	Program Communication Plan (PCP)	1.2	8/7/2023
C-01-PI01	Program Team	1.4	10/6/2023
C-01-PI02	Stakeholder Communications	1.2	8/7/2023
C-01-PI03	Public Involvement Event Checklist	1.1	8/7/2023
C-01-PI04	Public Meeting Schedule Reference	1.1	10/4/2023



IH 45 Program (BRY-45)

Bryan District

General Engineering Consultant (GEC)
Summary of Responsibilities



- I. Acronyms and Definitions
 - A. BRY-45 – Bryan District IH 45 Corridor program
 - B. BRY – Texas Department of Transportation Bryan District
 - C. GEC - General Engineering Consultant which includes AtkinsRéalis and its subconsultants
 - D. IAJR – Interstate Access Justification report
 - E. LDP – Low Distortion Projection which is a custom map projection being used on BRY-45
 - F. PDE - Project Development Engineer who is responsible for delivering a specific project(s) on BRY-45
 - G. Segment – specific section of IH 45 in BRY-45 depicted on the BRY-45 Segment Map
 - H. SM – Segment Manager who is a member of GEC staff, acting as “de facto” TxDOT Project Manager
 - I. SME - Subject Matter Expert: Members of BRY and GEC who provide technical discipline expertise and coordination between TxDOT, GEC, and PDE teams.

BRY-45 Program - Summary of GEC Responsibilities



- II. Program Management
 - A. Program Management Plan
 - B. Program Quality Management Plan
 - C. Standard Operating Procedures
 - D. Safety Field Work Procedures
 - E. Program specific design criteria and submittal checklists
 - F. Document Control via program Microsoft (MS) Teams and SharePoint sites
 - G. Program schedule
 - H. Budget and schedule dashboards
 - I. Review of Project Development Engineers' invoices and budget tracking
 - J. Program level cost estimates
 - K. Provide training for tools such as Microsoft applications, Bluebeam, iTwin and training for invoice submittals
 - L. General Project Development Engineer (PDE) contract management and oversight

BRY-45

Title: DTY Integration into ORD	DM-03
Original Issue Date: 08/23/2023	Revision: _____, Issue Date: _____

1. Purpose

The purpose of this Standard Operating Procedure is to provide guidance to the Project Development Engineer (PDE) for integrating a custom Geographic Coordinate System (GCS) into OpenRoads Designer (ORD). A DTY file is required and is provided here: [BRY-45_ORD_DTY](#). The provided DTY file will contain the necessary information for the Low Distortion Projection (LDP) GCS.

The guide provides general examples, as each PDE has their own policies, folder structures, and preferences, which they will need to account for when going through the guide. The PDE should reach out to their Segment Lead for additional guidance.

Importing the Texas State Plane Central data into the Low Distortion Projection (LDP) Geographic Coordinate System (GCS) used by the IH-45 program is provided in [DM-03-R01 Aligning Files in Different Coordinate Systems](#) (pending).

Information

OpenRoads Designer
Latest supported by TxDOT. Current: 10.10.01.03
DTY file: IH45-LDP.dty
The LDP GCS can be found under the utilities tab. See [Figure 1](#).

Figure 1: Coordinate System Dialog Button

When creating a project specific seed file, the GEC recommends that the PDE attach the LDP GCS to the seed file. If a generic seed file is used by other projects, it should not be attached.

BRY-45 LDP Integration Page 1 of 6 TxDOT | 8/2023

*Not a controlled document when printed. Refer to the BRY-45 SharePoint repository for current version.

BRY-45 Program - Summary of GEC Responsibilities



III. Program Coordination

- A. Project oversight and supervision of PDEs
- B. Host the Project specific MS Teams and SharePoint sites
- C. Manage the Project Development Engineers' deliverable submittal process
- D. Setup program and project meetings and manage OneNote notebooks
- E. Bryan District Subject Matter Expert (SME) coordination
- F. Assist BRY with Department and stakeholder coordination
- G. Permitting and developer request coordination
- H. TxDOTCONNECT updates

 Davis, Sarah 11:29 AM New

BRY-45_S03_Submittal_0002

This post is informing S03 of a newly approved PDE submittal. Project Controls has copied the submittal files into the appropriate CSJ channel for collaboration. Please click the link below to view all information regarding this submittal item.

[Link To Submittal Item](#)

Submittal No.: 0002
Submitted By: Cassandra Walloff
CSJ: 0675-06-105
Dept-Division: BRY-04-Design
SCHM Submittal (if applicable): Engineering Summary Report
PS&E Submittal (if applicable):

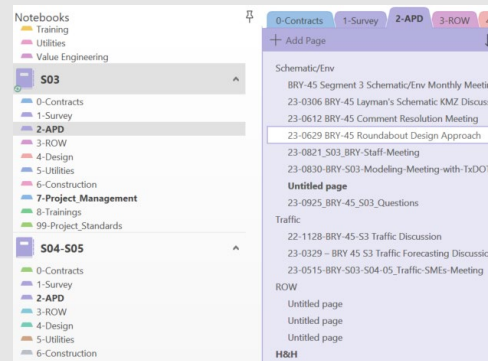

The screenshot shows a OneNote notebook with a table of contents on the left and a list of pages on the right. The table of contents includes sections for S03, S04-S05, and various project phases like 0-Contracts, 1-Survey, 2-APD, 3-ROW, 4-Design, 5-Utilities, 6-Construction, 7-Project_Management, 8-Trainings, and 99-Project_Standards. The right pane shows a list of pages including 'Schematic/Env', 'BRY-45 Segment 3 Schematic/Env Monthly Meetin', '23-0306 BRY-45 Layman's Schematic KMZ Discussi', '23-0612 BRY-45 Comment Resolution Meeting', '23-0629 BRY-45 Roundabout Design Approach', '23-0821_S03_BRY_Staff-Meeting', '23-0830-BRY-S03-Modeling-Meeting-with-TxDOT', 'Untitled page', '23-0925_BRY-45_S03_Questions', 'Traffic', '22-1128-BRY-45-S3 Traffic Discussion', '23-0329 - BRY 45 S3 Traffic Forecasting Discussio', '23-0515-BRY-S03-S04-05_Traffic-SMTs-Meeting', 'ROW', 'Untitled page', 'Untitled page', 'Untitled page', and 'H&H'.

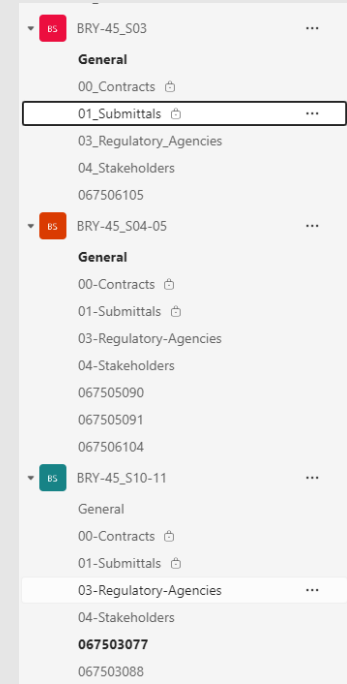

The screenshot shows a Microsoft Teams chat interface. The chat is titled 'BRY-45_S03'. The messages include a 'General' section with submittal items like '00_Contracts', '01_Submittals', '03_Regulatory_Agencies', '04_Stakeholders', and '067506105'. There is also a message from 'BRY-45_S04-05' with a 'General' section containing submittal items like '00-Contracts', '01-Submittals', '03-Regulatory-Agencies', '04-Stakeholders', '067505090', '067505091', and '067506104'. The chat ends with a message from 'BRY-45_S10-11' with a 'General' section containing submittal items like '00-Contracts', '01-Submittals', '03-Regulatory-Agencies', '04-Stakeholders', '067503077', and '067503088'.

BRY-45 Program - Summary of GEC Responsibilities



- IV. Preliminary Engineering
 - A. Schematic engineering oversight, guidance, coordination and review
 - B. Design exception review
 - C. Constructability review
 - D. Cost estimate review
 - E. IAJR document development and coordination
 - F. Oversight and review of PDE developed traffic and safety analyses and projections (Option-C)
 - G. Host Bluebeam and iTwin reviews for milestone submittal reviews and non-milestone reviews as-needed
 - H. SME coordination between TxDOT, GEC, and PDE SMEs
 - I. Financial Plan development

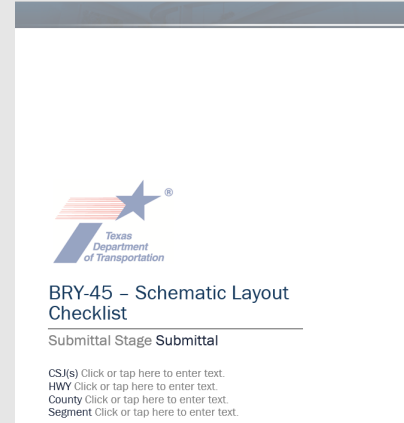

CSJ(s) Click or tap here to enter text.
 HWY Click or tap here to enter text.
 County Click or tap here to enter text.
 Segment Click or tap here to enter text.

Designer (DES): Click or tap here to enter text.
 Date: Click or tap to enter a date.
 Design Technician (TECH): Click or tap here to enter text.
 Date: Click or tap to enter a date.

Reviewer (REVR): Click or tap here to enter text.
 Date: Click or tap to enter a date.
 QA Reviewer (QA): Click or tap here to enter text.
 Date: Click or tap to enter a date.

Associated Checklist Manuals may be found [here](#).
 Link to GEP Folder may be found [here](#).

Review Stages Required for this project:	Preliminary Schematic (Draft)	Preliminary Schematic (Final)	Geometric Schematic (Draft)	Geometric Schematic (Final)
Date Review Completed for each stage:				

Has TxDOT's 3D Model Completeness Checklist been filled out:
 A copy of the 3D Model Completeness Checklist must be attached to this checklist when submitted.

YES NO

REVIEW REQUIREMENTS

REQUIREMENTS	N/A	DES	TECH	REVR	QA	COMMENTS
For Preliminary Schematic (Draft) Review:						
Title Block						
Verify title block @ both ends of each schematic.	<input type="checkbox"/>	<input type="checkbox"/>	<input type="checkbox"/>	<input type="checkbox"/>	<input type="checkbox"/>	
Verify text "Texas Department of Transportation" is shown.	<input type="checkbox"/>	<input type="checkbox"/>	<input type="checkbox"/>	<input type="checkbox"/>	<input type="checkbox"/>	
Verify TxDOT logo and copyright (Texas Department of Transportation) is shown.	<input type="checkbox"/>	<input type="checkbox"/>	<input type="checkbox"/>	<input type="checkbox"/>	<input type="checkbox"/>	

BRY-45_2023-013_Schematic_Layout_Checklist 4



V. Environmental

- A. Oversight and review of PDE developed environmental documents
- B. Environmental document support services required for environmental clearance
- C. NEPA Public Involvement Oversight
- D. Input of project segment information into Environmental Compliance Oversight System (ECOS)
- E. Conduct and facilitate Value Engineering studies

VI. Public Information

- A. Oversight of Public Involvement and Information activities
- B. Development of Program Public Involvement Plan for project development
- C. Development of Program-wide communications plan
- D. Coordination of Program and Project websites
- E. Provide Program hotline number, call log and call tracking

Bryan District I-45 Corridor Program

Purpose
The purpose of the program is to improve safety and mobility along I-45 in Bryan District in Walker, Madison, Leon and Freestone counties.

Proposed improvements

- Adding one mainlane in each direction.
- Converting two-way frontage roads to one-way frontage roads in communities.
- Improving interchanges (including the use of innovative intersections).
- Enhancing bicycle and pedestrian accommodation.
- Updating the roadway to current design standards.

Get involved
Studies for the Bryan District I-45 Corridor Program are in the early phase. Public involvement will be continuous throughout project development. Future dates and locations for public meetings and hearings will be listed on the website as they are scheduled.

Downloads

- [Program Fact Sheet](#)
- [Program Location Map](#)
- [Frequently Asked Questions](#)

Contact us

- Email.TxDOT.Bryan.District
- 936-209-4174

Contact for media

- Bob.Colwell
- 979-778-9764

I-45 Bryan District Project Map



VII. PS&E Development

- A. PS&E oversight, coordination and review
- B. Constructability reviews
- C. Design review coordination and tracking including hosting Bluebeam and iTwin reviews for milestone submittal reviews and non-milestone reviews as needed
- D. Cost estimate review
- E. Ready-to-let status tracking and coordination
- F. Project commitments tracking and coordination

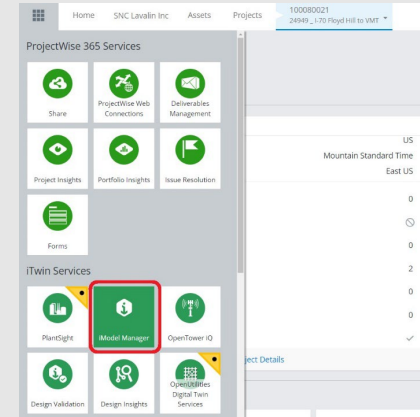
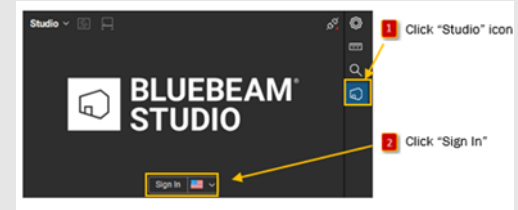

BRY-45 Program - Summary of GEC Responsibilities



VIII. Survey

- A. Pre-flight surveying – completed
- B. Coordination with TxDOT Photogrammetry
- C. Segment survey control – complete but to be supplemented as needed by PDEs
- D. Field survey support including review and coordination of Terrestrial Survey by PDEs
- E. Support for IH 45 Low Distortion Projection (LDP) implementation

IX. Right-of-Way

- A. Review and coordination of PDE ROW submittals
- B. Review of access management requests

X. Utilities

- A. Oversight, coordination and review of PDE utility engineering investigation (UEI, formerly SUE) and PDE utility design
- B. Supplemental utility engineering investigation, verification and coordination during construction
- C. Utility agreement and permit review

Bryan District Right of Way Map Checklist for Submittal Review

TxDOTCONNECT ROW Project No.: [REDACTED]

RCS#: [REDACTED] Highway: [REDACTED]

CCSR#: [REDACTED] County: [REDACTED]

Limits: [REDACTED] By: [REDACTED]

Date Reviewed: [REDACTED]

A. General Requirements

1. All map sheets are legible. Graphics and text must not overlap or be faded, light, dark, bolded, or fuzzy.
2. All maps plotted on 11"x17" map sheets with half-inch borders (in pdf format)
3. All map borders are a minimum of 1/4" with 1/4" margin on left
4. Drawings plotted in pdf format at 1" to 100' scale on 11"x17" sheets (Alternate scales require prior district approval).
5. Clear space (2") between match lines and borders
6. Text size and fonts are legible on 11"x17" sheets on all plots and use text style "2_Emphasis_Engr Vert" which equates to font style of Engineering Vert and text size of 7.8 at 1" to 100' scale on 11"x17" sheets.
7. Graphic files are in current MicroStation/DWG format; text files are in ASCII, text format
8. Graphic files conform to TxDOT's level menu
9. Use TxDOT's cell library for conventional signs, legends, and symbology. Currently: TX_Survey.cel
10. Show zero place holders in bearing for clarity (e.g., N 01°02'03"W)
11. The decimal places for the acquisition acreage are:
 - Four (4) decimal places for less than one (1) acre
 - Three (3) decimal places for one (1) acre or more
12. Area to be purchased by TxDOT is referred to as a Parcel. Area to be sold by TxDOT is referred to as a Tract.
13. Utility easements shown. Refer to [BRY-45 ROW-01 Standard Operating Procedures](#) for utility specific easement requirements.

B. Metadata/Notes

1. The basis of bearing shall be "Grid North"
2. Geographic Coordinate System: [Please Select GCS and Hit Tab Key](#)

Notes: The TxDOT IH 45 Low Distortion Projection (LDP) is required for BRY-45. For other projects, LDP may be used with prior approval.

For projects that use the Texas Coordinate System Central Zone, the combined adjustment factor must be entered in the box above.

3. Parameters are included as follows:
4. North American Vertical Datum 88 (NAVD 88) GEOID [REDACTED] (e.g., GEOID18) (if applicable)



Tentative* Procurement Schedule

Pre-RFP meeting	Late June 2024
RFP Posted in Bonfire	Mid July 2024
Proposal Closing Date	Early August 2024
Proposal Evaluation Complete	Late August 2024
Interviews	Mid September 2024
Provider Selection	Late September 2024
Finalize & Execute Contract	Late February 2025

*** All dates subject to change**



Thank you all for joining the Project Information meeting!

- Email all questions from the project information meeting to Allison.Kurwitz@txdot.gov by 5:00 p.m. CST, on December 15, 2023.

Subject line: **I-45 Corridor Program Meeting Question**

- Presentation, attendee list, and relevant questions/answers will be posted to TxDOT website under “Consultant Information Meetings”:

[Project Information Meeting – I-45 Corridor Program – Bryan District](#)